



THE CAROLINA



Room	Sq. Ft.	Dimensions	Theatre	Reception	Banquet (Plated/Buffer)	Classroom	Conference	Hollow Square (U-shape)
Grand Ballroom	9,600	60' x 160' x 15'9"	1,000	1,200	800/600	600	N/A	N/A
Tufts	1,200	30' x 40' x 15'9"	125	150	80/50	60	30	36/27
Ross	1,200	30' x 40' x 15'9"	125	150	80/50	60	30	36/27
Olmsted	2,400	60' x 40' x 15'9"	250	300	200/140	150	50	60/45
Callaway	2,400	60' x 40' x 15'9"	250	300	200/140	150	50	60/45
Oakley	2,400	60' x 40' x 15'9"	250	300	200/140	150	50	60/45
Foyer	6,900	15' Ceiling	N/A	800	N/A	N/A	N/A	N/A
Cardinal Ballroom	5,500	91'8" x 83'5" x 22' (Hexagonal)	500	600	350/280	300	40	60/45
South Room	2,205	54' x 40'10" x 14'	125	200	110/80	90	40	40/30
North Room	1,460	42'4" x 34'6" x 14'	100	150	80/60	80	30	36/27
Crystal Room	1,242	25'8" x 48'4"	N/A	60	60/40	N/A	N/A	N/A
Azalea Room	1,679	43'4" x 38'9" x 9'	60	100	80/60	50	30	30/24
Dogwood Room	532	35'6" x 15' x 11'	40	50	30/30	20	20	N/A
Kendall Room	608	16' x 38'	60	75	40/30	30	30	23/20
Taylor Room	256	16' x 16'	20	20	12 plated	10	10	23/20
Stevens Room	256	16' x 16'	20	20	12 plated	10	10	N/A
Stevens/Taylor	512	16' x 32'	40	40	30/20	20	20	23/20
Dedman Boardroom	390	15'5" x 26' x 8'11"	N/A	N/A	12 plated	N/A	12	N/A
Centennial Boardroom	714	21' x 34' x 8'11"	NA	N/A	18 plated	N/A	18	N/A
Wine Room	360	15' x 24' x 8'11"	N/A	N/A	12 plated	N/A	12	N/A
Villa Parlor (10)	600	20' x 30' x 8'	N/A	50	8 plated	N/A	8	N/A
Exhibit Center	14,000	160' x 79' x 10'5"	1,000	1,500	800/600	700	100	80
Exhibit Center Plaza*	5,883	53' x 111'	N/A	350	250/200	N/A	N/A	N/A
West Lawn*	12,000	80' x 150'	N/A	800	500 plated	N/A	N/A	N/A

THE CAROLINA

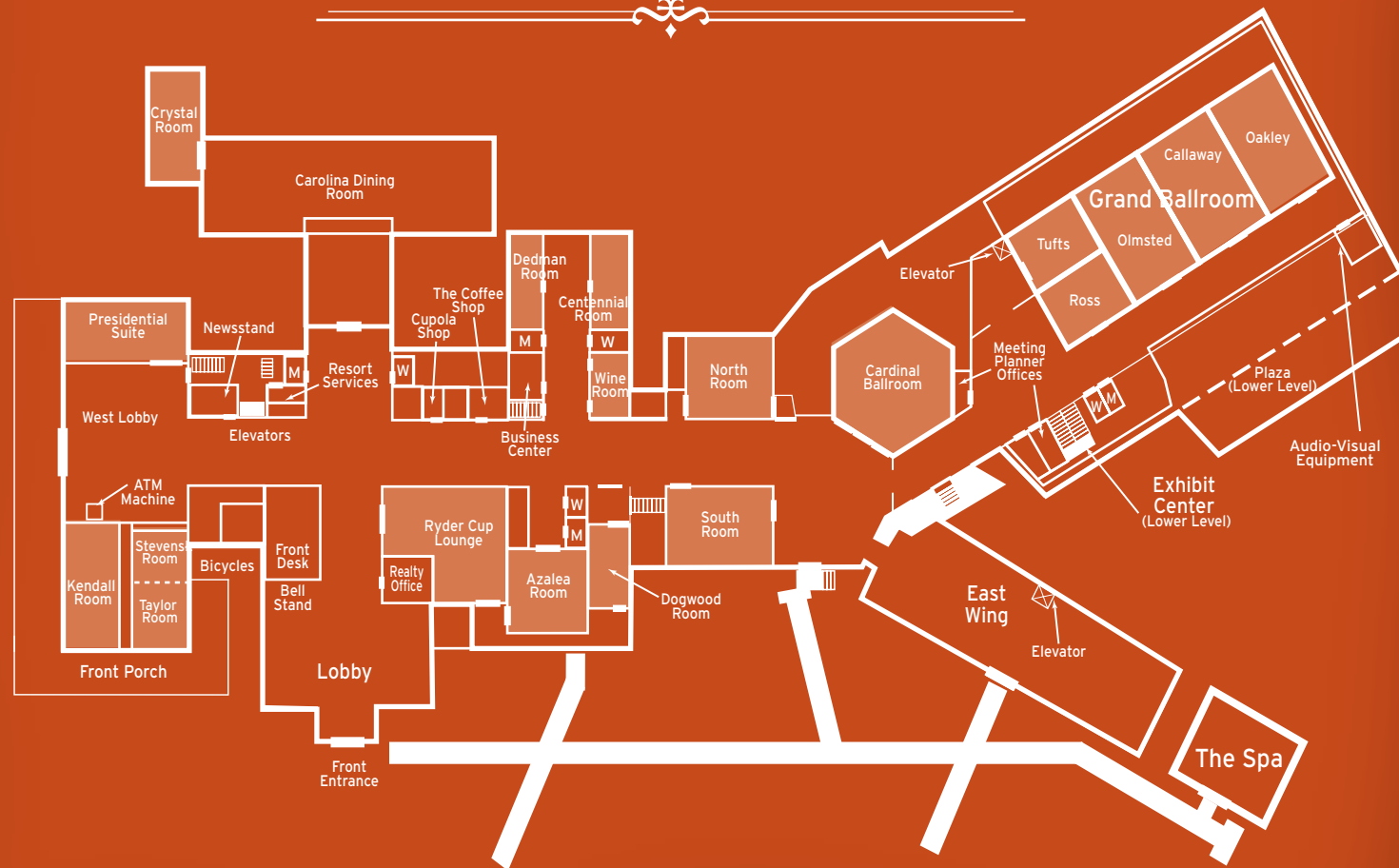

*Outdoor Venues



THE HOLLY INN



Room	Sq. Ft.	Dimensions	Theatre	Reception	Banquet (Plated/Buffer)	Classroom	Conference	Hollow Square (U-shape)
Evergreen Music Room	1,089 diameter	40'	90	125	80/65	65	40	40/32
Magnolia Room	580	29' x 20'	36	40	30/20	28	20	N/A
Gardenia Room	560	35' x 16'	N/A	N/A	20 Plated	N/A	20	N/A
Camellia Room	770	22' x 35'	50	70	60/60	40	32	32/26
Library	417	17'8" x 23'5"	30	25	20 plated	20	14	18/15



THE HOLLY INN

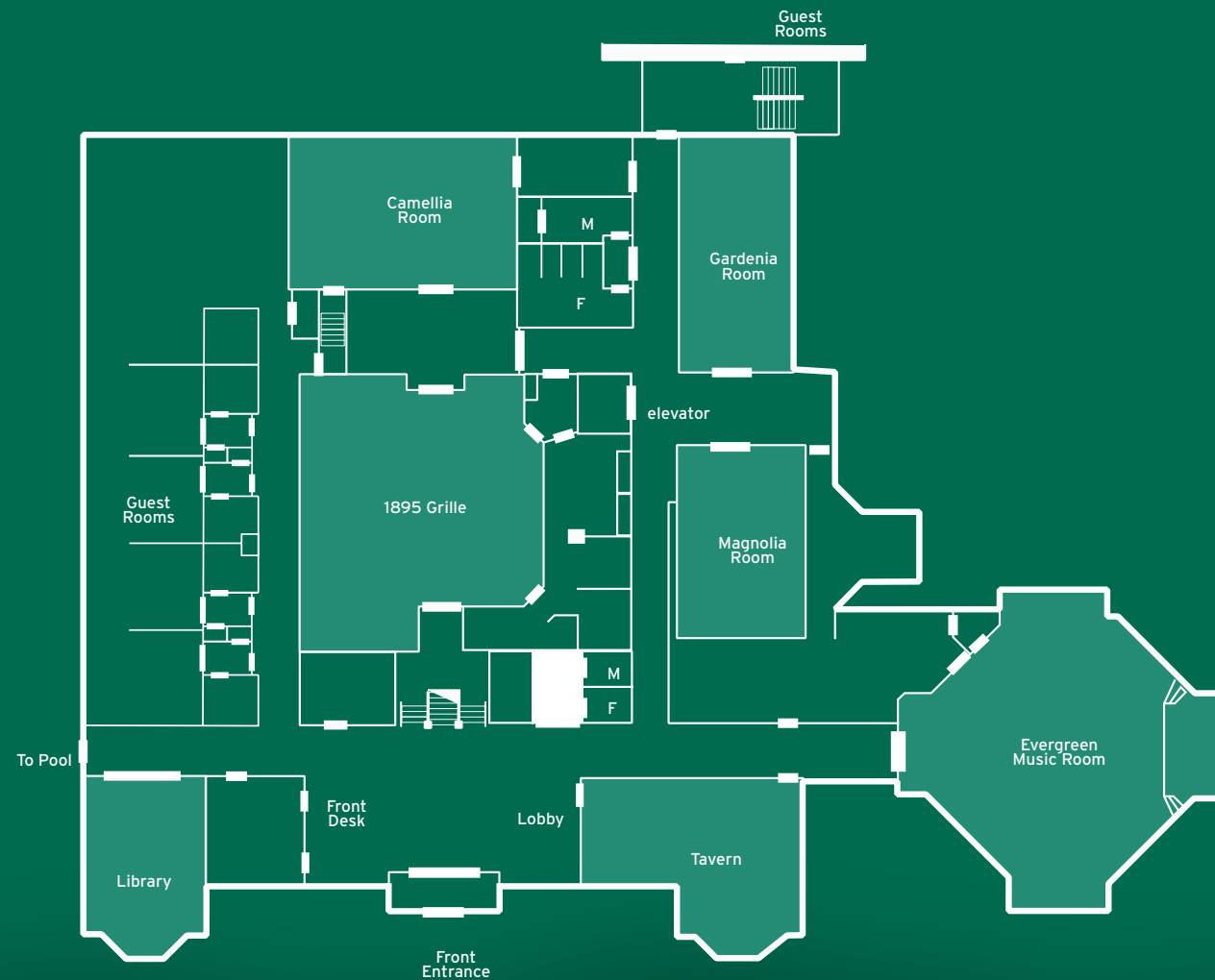

THE CLUBHOUSE VENUES



Venue	Sq. Ft.	Dimensions	Theatre	Reception	Banquet	Classroom	Conference	Hollow Square (U-shape)
St. Andrews Room	3,720	93' x 40' x 12'	300	300	200/150	120	N/A	60/50
Donald Ross Grill	4,250	85' x 50' x 15'	N/A	N/A	125	N/A	N/A	N/A
Donald Ross Grill Veranda*	N/A	N/A	N/A	200	100	N/A	N/A	N/A
Pro Shop Veranda*	N/A	N/A	N/A	150	80	N/A	N/A	N/A
Fairwoods Dining Room	1,728	64' x 22' x 16'	N/A	100	85/75	N/A	N/A	N/A
Fairwoods Veranda*	N/A	N/A	N/A	50	N/A	N/A	N/A	N/A
Centennial Dining Room	2,100	63' x 48' x 12'	N/A	150	100/100	N/A	N/A	N/A
Centennial Veranda*	N/A	N/A	N/A	75	N/A	N/A	N/A	N/A

*Outdoor Venues